



Tools and Materials Needed

- Chop saw or hacksaw with stainless steel cutting blade
- Level
- Measuring tape
- String or chalk line
- Hex keys: 2.5 mm, 3 mm, 4 mm, 5mm, 6 mm
- Utility knife
- Drill
- Drill bits for wood: 1/4", 5/32"
- Drill bit for stainless steel: 1/4"
- Socket or hex driver: 3/8"
- T40 Torx driver bit
- Box wrench: 10mm
- Rubber mallet
- Dish soap
- Non-corrosive exterior silicone caulking
- Concrete anchoring fasteners (for concrete applications only, see page 2 for details)

Fasteners Supplied



IMPORTANT INFORMATION

- Before beginning work, read this installation guide in its entirety including all warnings and important information.
- Throughout this installation guide, this symbol indicates important information: 
- Allowable glass panel width:
Decks: 18" - 36" Stairs: 7.5" to 10.25"
- Peak® MountainView™ railing is designed for Residential¹ use only, and not for any commercial use.
¹ Guards within dwelling units and exterior guards serving not more than two dwelling units.
- For multi-residential construction, please call Peak Customer Service at **1-877-883-PEAK (7325)** or email: cservice@peakproducts.com
- To prevent wood splitting and rot, drill pilot holes and coat fastener screw threads with non-corrosive exterior silicone caulking.
- For building code compliance on stairs always understand and comply with your local building codes for stair rail height and size of openings between glass panels and between a glass panel and post.
- Stair glass panels are designed for use on common stairs with an angle of 32° - 38°.
- For building code compliance and to ensure top rail brackets and screws do not interfere with glass panels (as shown in Figure 1 below):
 - Ensure the distance between glass panels is minimum 1/2" and maximum 2".
 - Ensure the distance between glass panels and posts is minimum 1-1/4" and maximum 2".
 - Ensure the distance between glass panels and walls is minimum 1-1/4" and maximum 2".
 - Ensure the distance between glass panels and the center of a corner bracket is minimum 1-3/4" and maximum 2-1/4".
 - Ensure the distance between glass panels and the center of an angle bracket is minimum 1-1/2" and maximum 2". Ensure total distance between glass panels does not exceed 3-15/16".
 - Ensure the distance between a post and a wall does not exceed 3-15/16".

• This installation guide is updated occasionally. Please scan the QR code to refer to the latest version at:

<https://peakproducts.com/en-ca/mountainview-glass-railing/installation-guides-videos/>



• Always understand and comply with your local building codes.⁺
⁺Conditions apply. For details scan the QR code to visit:

<https://peakproducts.com/en-ca/mountainview-glass-railing/compliance>



⚠WARNING Only use Peak® MountainView™ Spigot with 12 mm Peak® MountainView™ Tempered Glass Railing Panels along with a complete Peak® MountainView™ railing system, including Top Rails. Only use 8 mm Stair Tempered Glass Panels along with Peak® MountainView™ Stair Handrail and the complete system. Failure to do so may result in death or serious injury.

No representation or warranty is given that your particular application of these products complies with relevant building codes or that the fasteners provided or used are appropriate for your application. Consult with professionals and local building officials before beginning work: (i) to ensure compliance with relevant building codes for your application and for your proposed use of fasteners; (ii) to ensure the integrity of the structural components in connection with which these products are to be used; (iii) to identify appropriate safety gear that is to be used during installation such as a safety harness when working above ground; (iv) to ensure that the work area is free from utilities, services and hazards; and (v) to clarify any instructions or warnings that may not be clear. Work in a safe manner wearing protective gear such as gloves, eyewear, headwear, footwear and clothing. When using tools comply with operation manuals and instructions. Metal and glass may have sharp edges and could fragment or splinter during or as a result of handling or cutting. Do not use these products in connection with any substance that is or may be harmful or corrosive to the products. Inspect and maintain these products and the structural components that they are used in connection with on a regular basis, using professionals when appropriate.

No member of The Peak Group of Companies (as defined at www.peakproducts.com) shall be liable for any loss or damage resulting from the improper installation or use of this product. In the unlikely event that any member of The Peak Group of Companies becomes liable for any loss or damage, the aggregate liability shall be limited to the retail purchase price of the product. Peak products and associated materials are protected by patents, designs, copyrights and/or trademarks used under license from Peak Innovations Inc.

PMV_ii_ENG_CAN_V2

ANCHORING FASTENERS

For typical single-family detached houses, engineering design and testing has determined appropriate fasteners for the attachment of the spigot, post base, and end bracket to certain wood or concrete structures. Building codes may vary. Always understand and comply with your local building codes. For further information visit:

<https://peakproducts.com/en-ca/mountainview-glass-railing/compliance>
For multi-residential construction, please call Peak Customer Service at **1-877-883-PEAK (7325)** or email: cservice@peakproducts.com

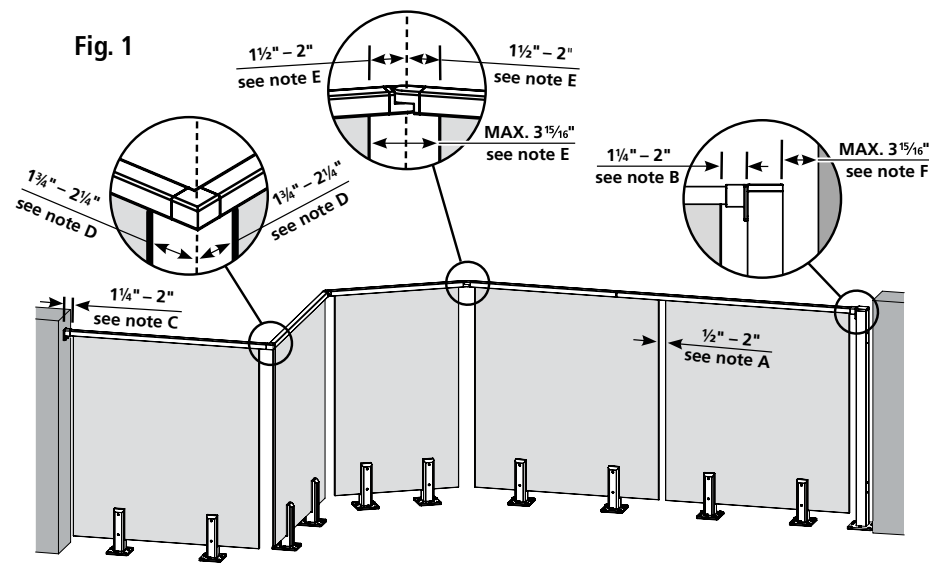

NEW SPF LUMBER					
Component	Fastener Required	Fastener Quantity	Minimum Embedment	Minimum Edge Distance	Pilot Hole
SPIGOT	3/8" x 6" Self-drilling wood screw (provided with product)	4	3-1/2"	3/4"	not required
FASCIA SPIGOT		2	3-1/2"	3/4"	not required
POST BASE		4	3-1/2"	3/4"	not required
FASCIA POST BASE		6	3-1/2"	3/4"	not required
END BRACKET	1/4" x 2" Lag Screw (provided with product)	2	1"	3/8"	5/32"

CONCRETE 20 MPa (3000 psi) minimum strength					
Component	Fastener Required	Fastener Quantity	Minimum Embedment	Minimum Edge Distance	Pilot Hole
SPIGOT	3/8" x 4" Buildex Tapcon+ (not provided)	4	3"	1-3/8"	3/8"
POST BASE		4	3"	1-3/8"	3/8"
END BRACKET	1/4" x 2-1/4" Buildex Tapcon (not provided)	2	2"	1-3/8"	3/16"

RAILING INSTALLATION WITH NO CORNER

Before starting this installation, mark the centerline of the railing using a string or chalk line, then mark the precise location of the components including glass panels, spigots, posts, top rail and brackets. Read all warnings and important information, and ensure the distances between components comply with Fig. 1 on page 2.

⚠ Always use two people to handle glass panels. Always lift a glass panel by its sides. Tempered glass is extremely fragile – do not bump the edges or contact with metal. Always use protective gear including eyewear and gloves when handling glass panels.

1 Measure and mark the position of all spigots and posts and ensure they are aligned using a string or chalk line. Also ensure spigots are positioned at the quarter points of each glass panel (each glass panel requires two spigots). For wood attachment, install four 6" self-drilling wood screws through each corner of the spigots and post bases with levelling plates. Do not fully tighten.

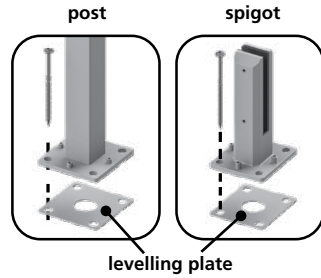

⚠ To prevent splitting of deck boards, drill four 1/4" pilot holes through deck boards (but not into deck structure).

⚠ To prevent wood splitting and rot, drill pilot holes and coat fastener screw threads with non-corrosive exterior silicone caulking.

⚠ For concrete attachment, refer to page 3 for anchoring fastener recommendations.

2 Install the first glass panel into two spigots and ensure it is centered. To secure glass to spigot, tighten two screws on each spigot using 5 mm hex key. Repeat for all remaining sections.

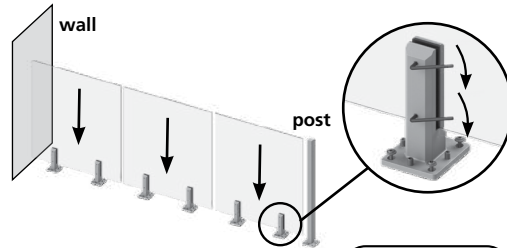

⚠ Do NOT overtighten screws.

3 Adjust the four levelling screws on each spigot with 5 mm hex key until top of all glass panels are aligned and level with deck surface. Then tighten all 6" self-drilling wood screws.

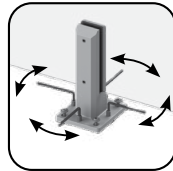

4 To determine the length of top rail, position end brackets on wall or post at each end of railing. Measure distance to fit top rail between end brackets.

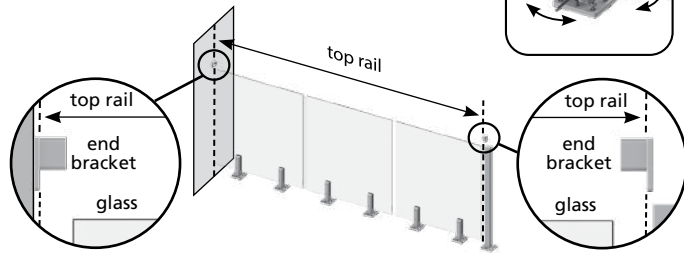

5 **⚠** Only complete this step for top rails longer than 8'.

To join two top rails together, insert mid bracket into first and second top rails.

⚠ Ensure mid bracket is fully engaged in each top rail.

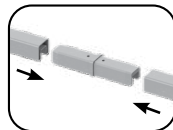

6 Remove gasket and cut top rail using chop saw or hacksaw with stainless steel cutting blade.

PRO TIP: Measure twice, cut once!

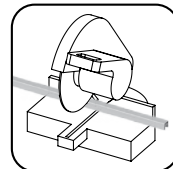

7 **⚠** Only complete this step for ends of top rail that are not factory-cut. Drill 1/4" hole through bottom of rail 5/8" from end using drill bit for stainless steel.

PRO TIP: Be careful to not drill through top of rail!

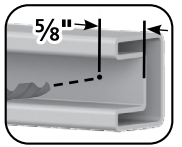

8 A. Attach end brackets to top rail with 5/16" pan head screws using 3 mm hex key. To allow for top rail length variability, do not fully tighten screw; the connection should be loose (will be secured in Step 13).

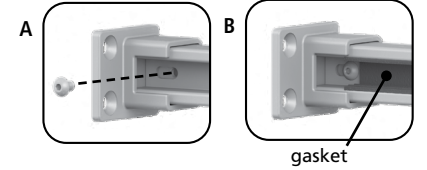

B. Using utility knife, cut gasket to length shorter than top rail to leave end bracket screws exposed. Then reinstall gasket inside top rail.

9 **⚠** Only complete this step if you are connecting an end bracket to a post. Use a 3 mm hex key to remove hole cover from top two holes in post.

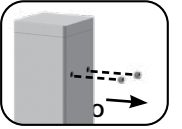

10 Position rail on top of glass panels. Ensure that top rail gasket and top edge of glass panels are well lubricated with liquid soap before installing onto glass panel. Push rail down on to the glass panels until fully seated.

PRO TIP: Tap handrail into place using rubber mallet.

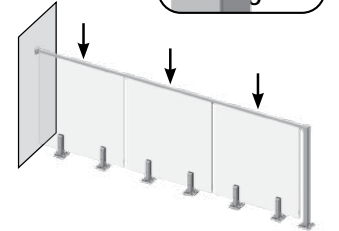

11 **⚠** Only complete this step if you are connecting an end bracket to wood or concrete.

For wood attachment:

A. Mark hole locations for end bracket on wall. Then remove top rail and brackets, and remove first and last glass panels.

B. Drill 5/32" pilot holes, 2" deep, then reinstall first and last glass panels, top rail, and brackets.

C. Secure bracket using 2" lag screws with washers.

⚠ For concrete attachment, refer to page 3 for anchoring fastener recommendations.

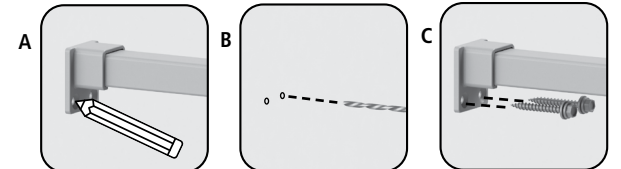

12 **⚠** Only complete this step if you are connecting an end bracket to a post.

A. Secure end bracket to post using two 5/8" flat head screws.

B. Turn set screws on post base with 5 mm hex key until they touch the leveling plate. Then, tighten 6" self-drilling wood screws to secure post.

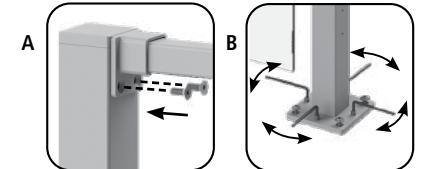

13 A. To secure top rail to end brackets, tighten 5/16" pan head screws with 4 mm hex key.

B. Install base covers on spigots and posts.

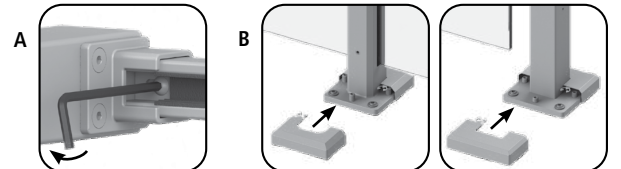

RAILING INSTALLATION WITH CORNER

Before starting this installation, mark the centerline of the railing using a string or chalk line, then mark the precise location of the components including glass panels, spigots, posts, top rail and brackets. Read all warnings and important information, and ensure the distances between components comply with Fig. 1 on page 2.

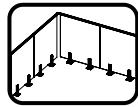

1 Always use two people to handle glass panels. Always lift a glass panel by its sides. Tempered glass is extremely fragile – do not bump the edges or contact with metal. Always use protective gear including eyewear and gloves when handling glass panels.

1 Measure and mark the position of all spigots and posts and ensure they are aligned using a string or chalk line. Also ensure spigots are positioned at the quarter points of each glass panel (each glass panel requires two spigots). For wood attachment, install four 6" self-drilling wood screws through each corner of the spigots and post bases with levelling plates. Do not fully tighten.

⚠ To prevent splitting of deck boards, drill four 1/4" pilot holes through deck boards (but not into deck structure).

⚠ To prevent wood splitting and rot, drill pilot holes and coat fastener screw threads with non-corrosive exterior silicone caulking.

⚠ For concrete attachment, refer to page 3 for anchoring fastener recommendations.

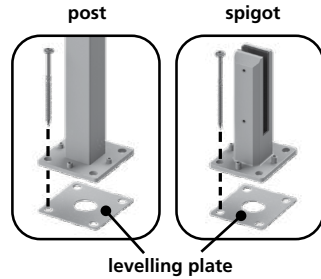

2 Install the first glass panel into two spigots and ensure it is centered. To secure glass to spigot, tighten two screws on each spigot using 5 mm hex key. Repeat for all remaining sections.

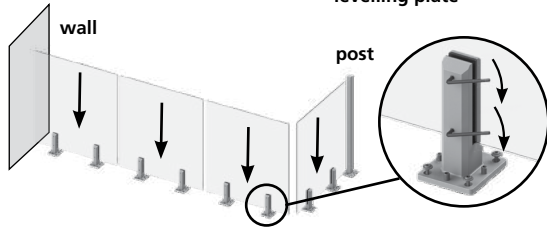

3 Adjust the four levelling screws on each spigot with 5 mm hex key until top of all glass panels are aligned and level with deck surface. Then tighten all 6" self-drilling wood screws.

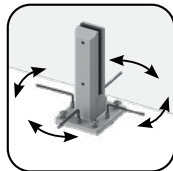

4 To determine the length of top rail (1), position end bracket on wall, and corner or angle bracket at corner. Measure distance to fit top rail between brackets. Repeat procedure to determine length of top rail (2).

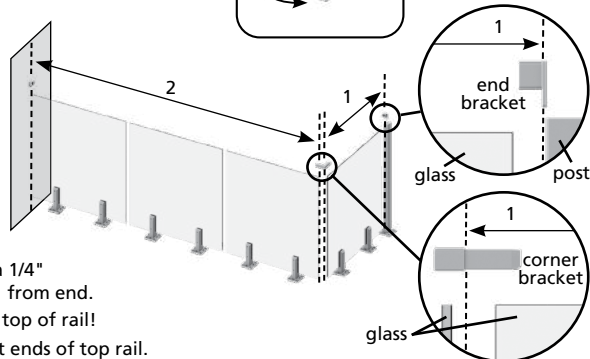

5 To install a corner or angle bracket:
A. Remove gasket from top rails. Drill a 1/4" hole through bottom of top rail, 3/8" from end.

PRO TIP: Be careful to not drill through top of rail!

⚠ Drilling not required for factory-cut ends of top rail.

B. Insert bracket into first and second top rails. Ensure bracket is fully engaged in each top rail.

C. Secure angle or corner bracket to top rails with 5/16" pan head screws using 3 mm hex key.

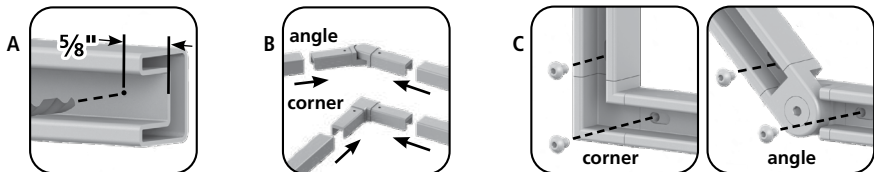

6 ⚠ Only complete this step for straight lengths of top rail exceeding 8'.

To join two top rails together:

A. Drill 1/4" holes through top of rails, 3/8" from end.

B. Insert bracket into first and second top rails. Ensure bracket is fully engaged in each top rail.

C. Secure bracket to top rails with 5/16" pan head screws using 3 mm hex key.

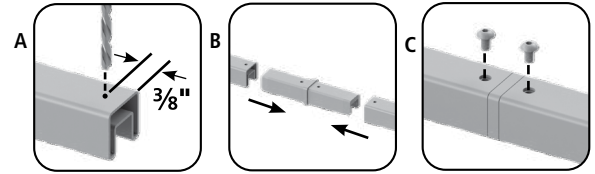

PRO TIP: For additional rail connection options, refer to our website.

7 ⚠ Only complete this step for ends of top rail that are not factory-cut.

Drill 1/4" hole through bottom of rail 5/8" from end using drill bit for stainless steel.

PRO TIP: Be careful to not drill through top of rail!

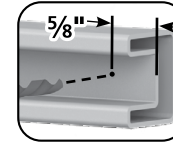

8 Remove gasket and cut top rail using chop saw or hacksaw with stainless steel cutting blade.

PRO TIP: Measure twice, cut once!

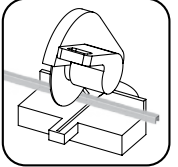

9 A. Attach end brackets to top rail with 5/16" pan head screws using 3 mm hex key. To allow for top rail length variability, do not fully tighten screw; the connection should be loose (will be secured in Step 12).

B. Using utility knife, cut gasket to leave screws exposed at end, corner and angle bracket locations. Then reinstall gasket inside top rail.

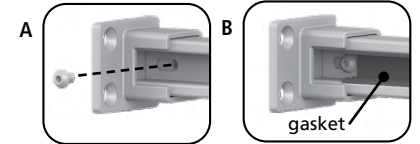

10 ⚠ Only complete this step if you are connecting an end bracket to a post. Use a 3 mm hex key to remove hole cover from top two holes in post.

11 Position top rail on top of glass panels. Ensure that top rail gasket and top edge of glass panels are well lubricated with liquid soap before installing onto glass panel. Push top rail down on to the glass panels until fully seated.

PRO TIP: Tap handrail into place using rubber mallet.

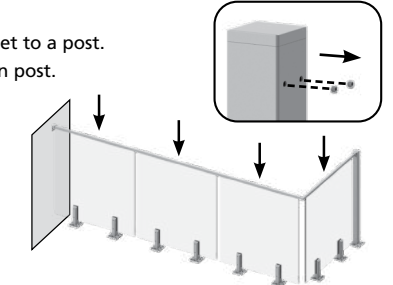

12 ⚠ Only complete this step if you are connecting an end bracket to wood or concrete.

For wood attachment:

A. Mark hole locations for end bracket on wall. Then remove top rail and brackets, and remove first and last glass panels.

B. Drill 5/32" pilot holes, 2" deep, then reinstall first and last glass panels, top rail, and brackets.

C. Secure bracket using 2" lag screws with washers.

⚠ For concrete attachment, refer to page 3 for anchoring fastener recommendations.

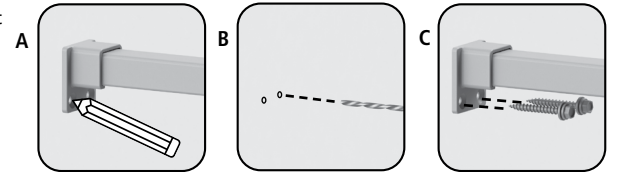

13 ⚠ Only complete this step if you are connecting an end bracket to a post.

A. Secure end bracket to post using two 5/8" flat head screws.

B. Turn set screws on post base with 5 mm hex key until they touch the levelling plate. Then, tighten 6" self-drilling wood screws to secure post.

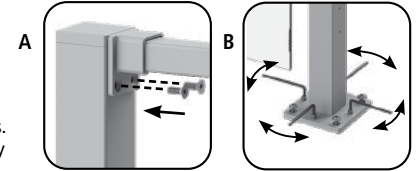

14 A. To secure top rail to end brackets, tighten 5/16" pan head screws with 4 mm hex key.

B. Install base covers on spigots and posts.

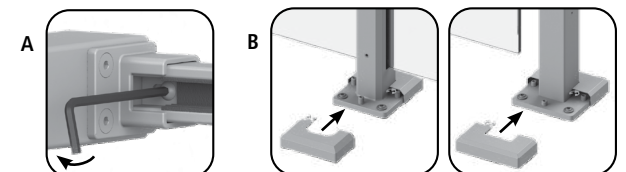

STAIR INSTALLATION

Read all warnings and important information, and ensure the distances between glass panels, glass panels and posts, and posts and walls do not exceed 3-15/16".

- ⚠ Stair glass panels are designed for use on common stairs with an angle of 32° - 38°.
- ⚠ Always use two people to handle glass panels. Always lift a glass panel by its sides. Tempered glass is extremely fragile – do not bump the edges or contact with metal. Always use protective gear including eyewear and gloves when handling glass panels.

1 Measure and mark the position of all posts and ensure they are aligned using a string or chalk line. For wood attachment, install four 6" self-drilling wood screws through each corner of the post.

- ⚠ To prevent splitting of deck boards, drill four 1/4" pilot holes through deck boards (but not into deck structure).
- ⚠ For concrete attachment, refer to page 3 for anchoring fastener recommendations
- ⚠ To prevent wood splitting and rot, drill pilot holes and coat fastener screw threads with non-corrosive exterior silicone caulking.

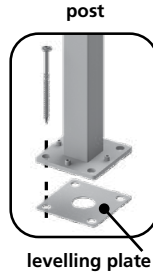

2 Adjust the four levelling screws on each post with 5 mm hex key until posts are plumb. Then tighten all 6" self-drilling wood screws.

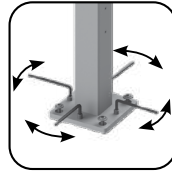

3 Position stair rail end brackets and mid brackets at tops of post and measure the distance between them.

PRO TIP: Use clamps to secure end brackets and ensure that the rail will be parallel with the stair.

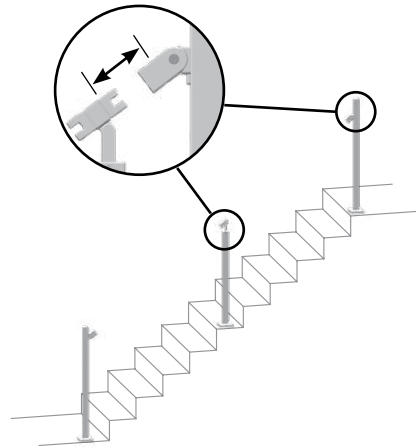

PRO TIP: Not all applications require a mid post. For installation with only one section, measure the inside distance between two brackets.

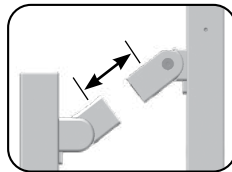

4 Cut stair handrail using chop saw or hacksaw with stainless steel cutting blade.
PRO TIP: Measure twice, cut once!

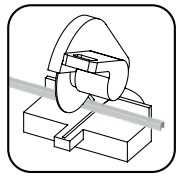

5 ⚠ Only complete this step for ends of stair handrail that are not factory-cut. Drill 1/4" hole through bottom of rail 5/8" from end using drill bit for stainless steel.
PRO TIP: Be careful to not drill through top of rail!

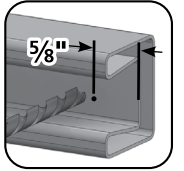

6 **A.** Attach stair rail bracket(s) and stair mid post (if used) to stair handrail with 5/16" pan head screws using 3 mm hex key.
B. Position rail parallel with stairs 35 5/8" (905 mm) above stair nosing and clamp bracket on to post. Check rail position by fitting stair glass panels into position 9/16" above stair tread. Adjust stair handrail position if required. Mark bracket hole positions on post.

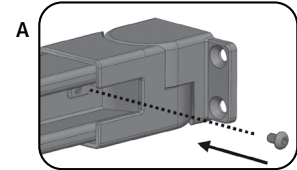

PRO TIP: Position cut end inside stair rail bracket to conceal cut end.

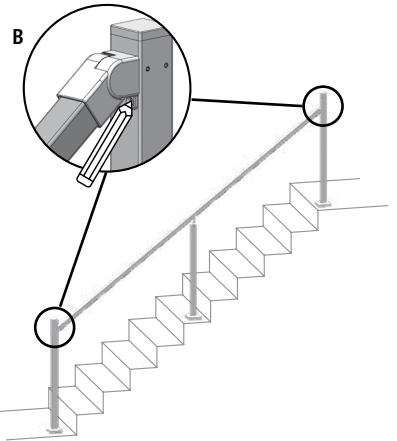

7 Drill two 1/4" holes into post using drill bit for stainless steel at marked positions.

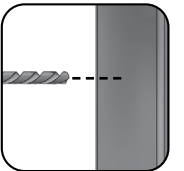

8 Disassemble stair rail bracket using 5mm hex key.

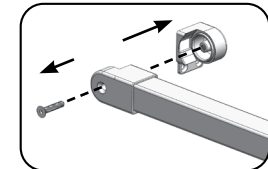

- 9** **A.** Use a piece of painters tape to secure 10 mm hex nut in a 10 mm box wrench.
B. Position nut inside post and fasten back of stair rail bracket to post using two 5/8" flat head screws.

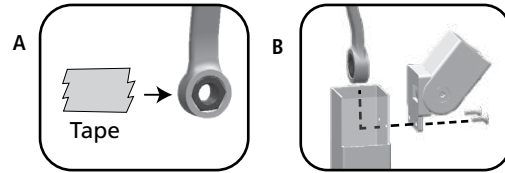

- 10** Remove a bracket from one end of stair handrail using 3 mm hex key. Slide glass brackets into stair handrail. Reassemble bracket to stair handrail.

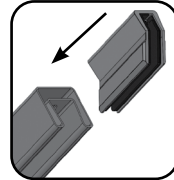

- 11** Put stair handrail in position and reassemble stair rail bracket using 5 mm hex key.

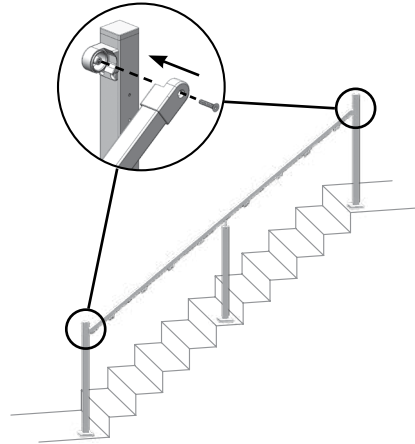

- 12** Repeat Steps 7 to 10 for each section of handrail.

- 13** **A.** Align all stair handrail sections, adjusting all posts as required.
 For installations with stair mid post:
B. Adjust the mid post connector height so the rail is straight and tighten all four screws using a 3 mm hex key.

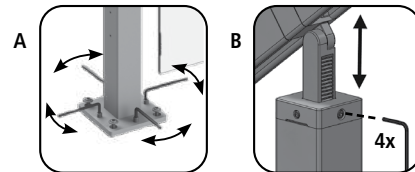

- 14** Position each upper stair glass bracket at the centre of each stair tread and secure in place by tightening the set screw inside using a 2.5 mm hex key.

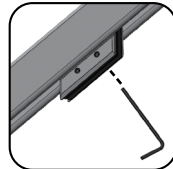

- 15** **A.** Remove side plate of bottom stair glass bracket and the rubber spacers using a 4 mm hex key.
B. Position each lower bracket aligned with each upper bracket.
C. Secure to tread surface using two 2" wood screws.

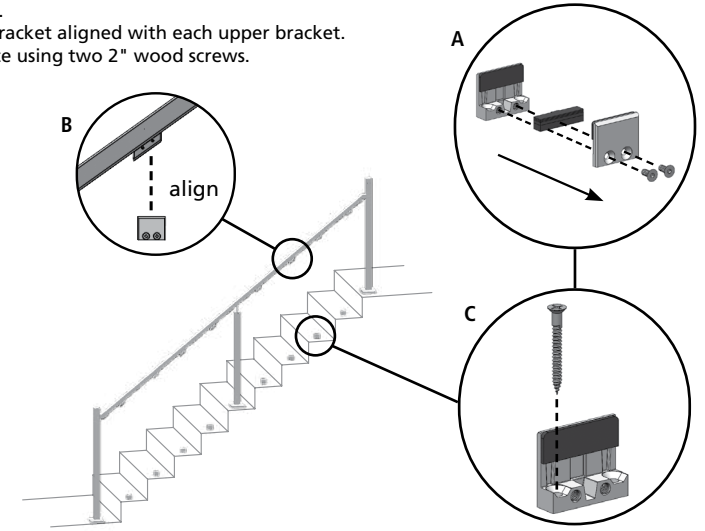

- 16** **A.** Position each glass panel by swinging up into top glass brackets. The panel should be positioned so the top edge is contained inside the top rail.
B. Slide spacers under glass panel to set height.
C. Secure side plate of bottom stair glass bracket
D. Tighten two screws on top glass bracket to secure.
 Repeat for all glass panels.

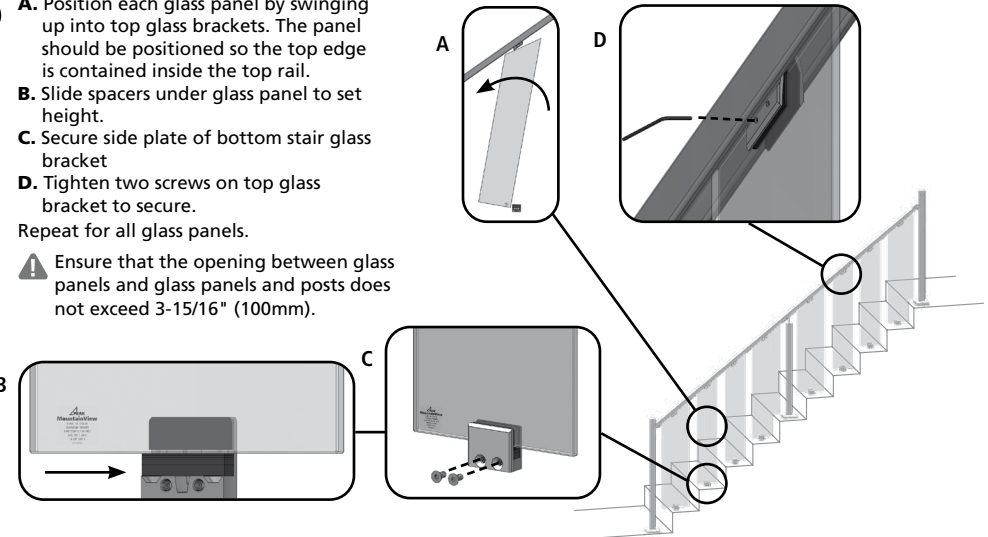

! Ensure that the opening between glass panels and glass panels and posts does not exceed 3-15/16" (100mm).

- 17** Install base covers on posts.

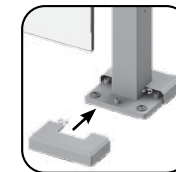

FASCIA RAILING INSTALLATION WITH NO CORNER

Before starting this installation, mark the precise location of the components including glass panels, spigots, posts, top rail and brackets. Read all warnings and important information, and ensure the distances between components comply with Fig. 1 on page 2.

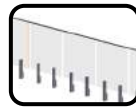

⚠ Always use two people to handle glass panels. Always lift a glass panel by its sides. Tempered glass is extremely fragile – do not bump the edges or contact with metal. Always use protective gear including eyewear and gloves when handling glass panels.

1 Measure and mark the position of all fascia posts and fascia spigots, aligned using a string or chalk line with level ensuring that the marked locations are plumb and that the leveling plate is 2" below deck surface. Also ensure fascia spigots are positioned at the quarter points of each glass panel (each glass panel requires two spigots).

⚠ Fascia posts will be installed in Step 12.

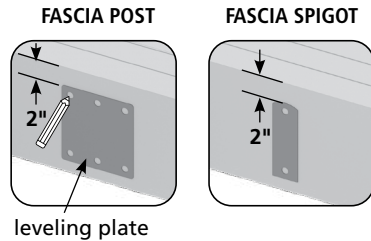

2 For wood attachment, install two 6" self-drilling wood screws through each fascia spigot with leveling plate. Do not fully tighten. Place shims between the fascia spigot and the leveling plate to align and plumb all hardware.

⚠ To prevent wood splitting and rot, drill pilot holes and coat fastener screw threads with non-corrosive exterior silicone caulking.

⚠ For concrete attachment, refer to page 3 for anchoring fastener recommendations.

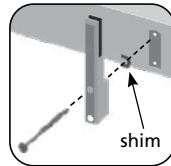

3 Install the first glass panel into two fascia spigots and ensure it is centered. Ensure the glass is level then tighten the fascia spigots to the deck. To secure glass to fascia spigot, tighten two screws on each fascia spigot using 5 mm hex key. Repeat for all remaining sections.

⚠ Do NOT overtighten screws.

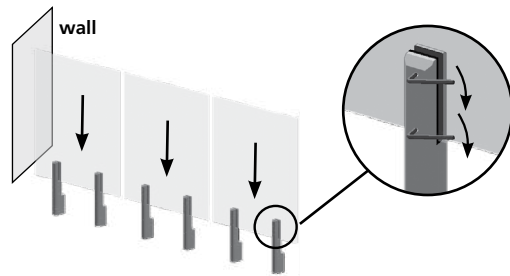

4 To determine the length of top rail, position end brackets on wall. Measure distance to fit top rail between end brackets. For terminations that will use a fascia post, cut rail to extend between 1-1/8" and 1-3/4" past the end of glass panel.

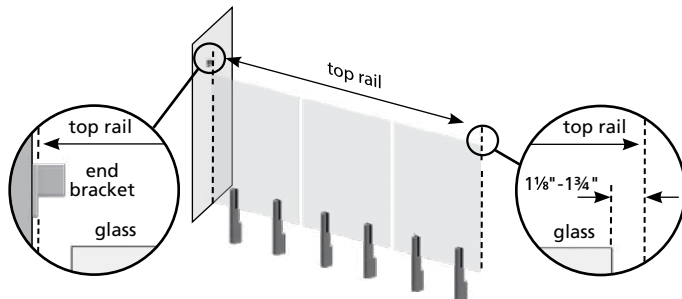

5 **⚠** Only complete this step for top rails longer than 8'. To join two top rails together, insert mid bracket into first and second top rails. **⚠** Ensure mid bracket is fully engaged in each top rail.

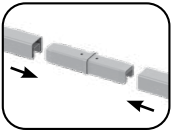

6 Remove gasket and cut top rail using chop saw or hacksaw with stainless steel cutting blade. **PRO TIP:** Measure twice, cut once!

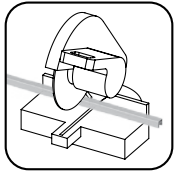

7 **⚠** Only complete this step for ends of top rail that are not factory-cut. Drill 1/4" hole through bottom of rail 5/8" from end using drill bit for stainless steel. **PRO TIP:** Be careful to not drill through top of rail!

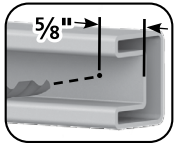

8 A. Attach end brackets to top rail with 5/16" pan head screws using 3 mm hex key. To allow for top rail length variability, do not fully tighten screw; the connection should be loose (will be secured in Step 13). B. Using utility knife, cut gasket to length shorter than top rail to leave end bracket screws exposed. Then reinstall gasket inside top rail.

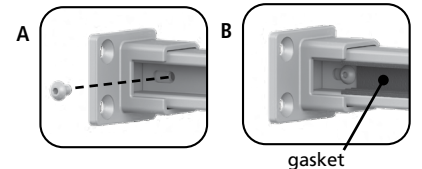

9 Position rail on top of glass panels. Ensure that top rail gasket and top edge of glass panels are well lubricated with liquid soap before installing onto glass panel. Push rail down on to the glass panels until fully seated. **PRO TIP:** Tap handrail into place using rubber mallet.

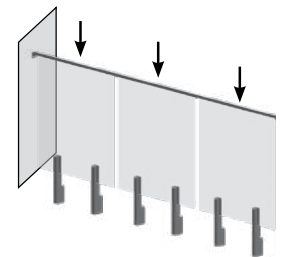

10 **⚠** Only complete this step if you are connecting an end bracket to wood or concrete. For wood attachment: A. Mark hole locations for end bracket on wall. Then remove top rail and brackets, and remove first and last glass panels. B. Drill 5/32" pilot holes, 2" deep, then reinstall first and last glass panels, top rail, and brackets. C. Secure bracket using 2" lag screws with washers.

⚠ For concrete attachment, refer to page 3 for anchoring fastener recommendations.

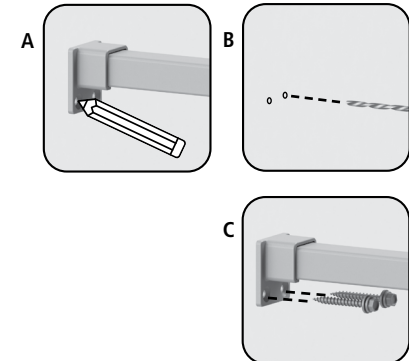

- 11** ⚠️ Only complete this step to reverse position of end bracket and gate hardware mounting holes on fascia post.

- A. Use a 6mm hex key to remove 4 bolts from fascia post.
- B. Pull post off base and rotate 180°.
- C. Use a 6 mm hex key to reinstall 4 bolts to secure fascia post.

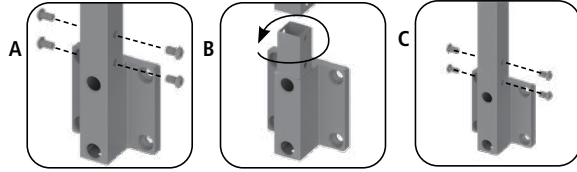

- 12** ⚠️ Only complete this step if you are connecting an end bracket to a post.

- A. Use a 3 mm hex key to remove hole cover from top two holes in post.
- B. Secure end bracket to post using two 5/8" flat head screws.
- C. Install six 6" self-drilling wood screws through each fascia post with leveling plate and add shim as needed to plumb the fascia post.

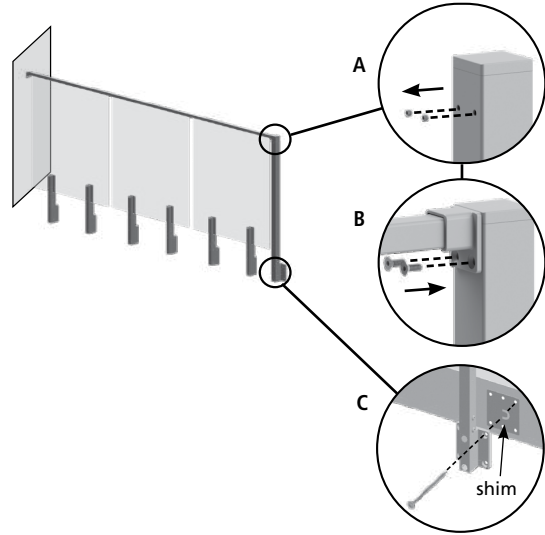

- 13** To secure top rail to end brackets, tighten 5/16" pan head screws with 4 mm hex key.

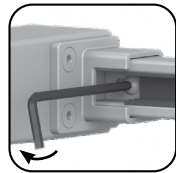

- 14** Install caps onto each fascia post and fascia spigot.

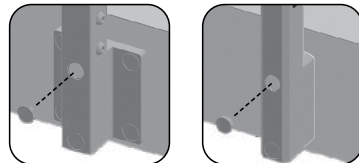

FASCIA RAILING INSTALLATION WITH CORNER

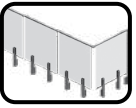

Before starting this installation, mark the precise location of the components including glass panels, spigots, posts, top rail and brackets. Read all warnings and important information, and ensure the distances between components comply with Fig. 1 on page 2.

- ⚠️ Always use two people to handle glass panels. Always lift a glass panel by its sides. Tempered glass is extremely fragile – do not bump the edges or contact with metal. Always use protective gear including eyewear and gloves when handling glass panels.

- 1** Measure and mark the position of all fascia posts and fascia spigots, aligned using a string or chalk line with level ensuring that the marked locations are plumb and that the leveling plate is 2" below deck surface. Also ensure fascia spigots are positioned at the quarter points of each glass panel (each glass panel requires two spigots).

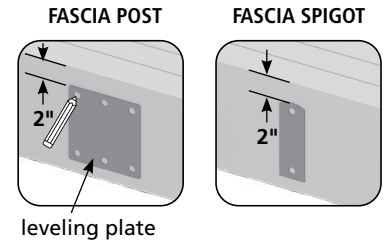

- ⚠️ Fascia posts will be installed in Step 12.

- 2** For wood attachment, install two 6" self-drilling wood screws through each fascia spigot with leveling plate. Do not fully tighten. Place shims between the fascia spigot and the leveling plate to align and plumb all hardware.

- ⚠️ To prevent wood splitting and rot, drill pilot holes and coat fastener screw threads with non-corrosive exterior silicone caulking.

- ⚠️ For concrete attachment, refer to page 3 for anchoring fastener recommendations.

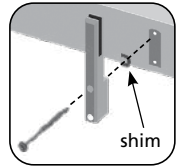

- 3** Install the first glass panel into two fascia spigots and ensure it is centered. Ensure the glass is level then tighten the fascia spigots to the deck. To secure glass to fascia spigot, tighten two screws on each fascia spigot using 5 mm hex key. Repeat for all remaining sections.

- ⚠️ Do NOT overtighten screws.

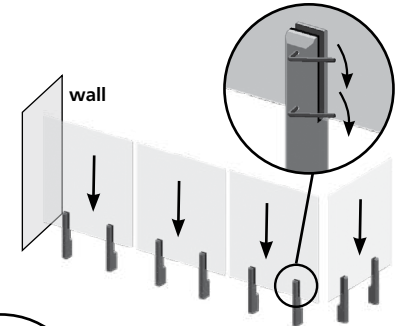

- 4** To determine the length of top rail (1), position end brackets on wall, and corner or angle bracket at corner. Measure distance to fit top rail between brackets. For terminations that will use a fascia post, cut rail to extend between 1-1/8" and 1-3/4" past the end of glass panel. Repeat procedure to determine length of top rail (2).

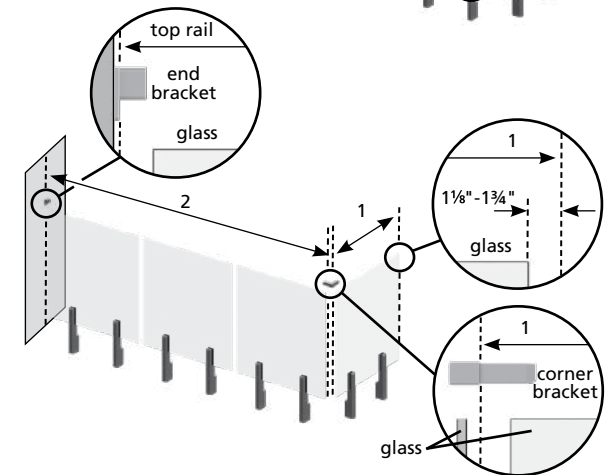

- 5** To install a corner or angle bracket:
A. Remove gasket from top rails. Drill a 1/4" hole through bottom of top rail, 3/8" from end.
PRO TIP: Be careful to not drill through top of rail!

! Drilling not required for factory-cut ends of top rail.

- B.** Insert bracket into first and second top rails. Ensure bracket is fully engaged in each top rail.
C. Secure angle or corner bracket to top rails with 5/16" pan head screws using 3 mm hex key.

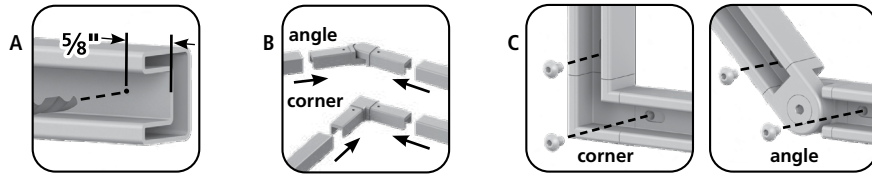

- 6** **!** Only complete this step for straight lengths of top rail exceeding 8'.

To join two top rails together:

- A.** Drill 1/4" holes through top of rails, 3/8" from end.
B. Insert bracket into first and second top rails. Ensure bracket is fully engaged in each top rail.
C. Secure bracket to top rails with 5/16" pan head screws using 3 mm hex key.

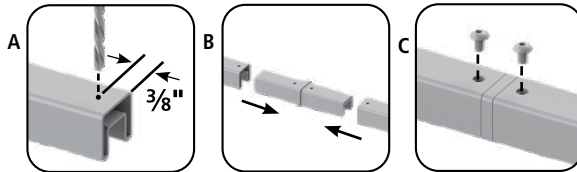

PRO TIP: For additional rail connection options, refer to our website.

- 7** **!** Only complete this step for ends of top rail that are not factory-cut.

Drill 1/4" hole through bottom of rail 5/8" from end using drill bit for stainless steel.

PRO TIP: Be careful to not drill through top of rail!

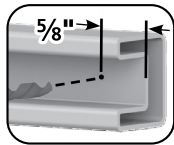

- 8** Remove gasket and cut top rail using chop saw or hacksaw with stainless steel cutting blade.

PRO TIP: Measure twice, cut once!

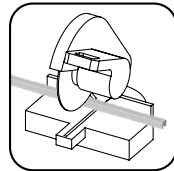

- 9** **A.** Attach end brackets to top rail with 5/16" pan head screws using 3 mm hex key. To allow for top rail length variability, do not fully tighten screw; the connection should be loose (will be secured in Step 12).
B. Using utility knife, cut gasket to leave screws exposed at end, corner and angle bracket locations. Then reinstall gasket inside top rail.

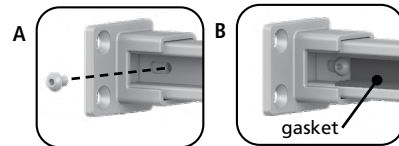

- 10** Position top rail on top of glass panels. Ensure that top rail gasket and top edge of glass panels are well lubricated with liquid soap before installing onto glass panel. Push top rail down on to the glass panels until fully seated.

PRO TIP: Tap handrail into place using rubber mallet.

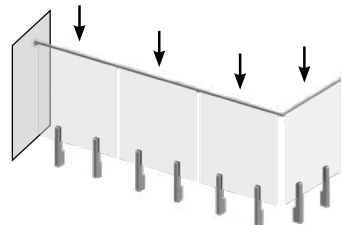

- 11** **!** Only complete this step if you are connecting an end bracket to wood or concrete.

For wood attachment:

- A.** Mark hole locations for end bracket on wall. Then remove top rail and brackets, and remove first and last glass panels.
B. Drill 5/32" pilot holes, 2" deep, then reinstall first and last glass panels, top rail, and brackets.
C. Secure bracket using 2" lag screws with washers.

! For concrete attachment, refer to page 3 for anchoring fastener recommendations.

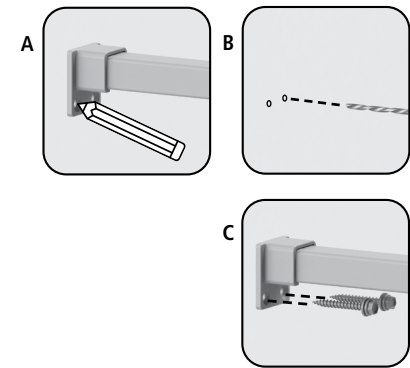

- 12** **!** Only complete this step to reverse position of end bracket and gate hardware mounting holes on fascia post.

- A.** Use a 6mm hex key to remove 4 bolts from fascia post.
B. Pull post off base and rotate 180°.
C. Use a 6 mm hex key to reinstall 4 bolts to secure fascia post.

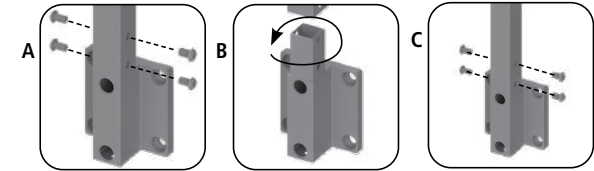

- 13** **!** Only complete this step if you are connecting an end bracket to a post.

- A.** Use a 3 mm hex key to remove hole cover from top two holes in post.
B. Secure end bracket to post using two 5/8" flat head screws.
C. Install six 6" self-drilling wood screws through each fascia post with leveling plate and add shim as needed to plumb the fascia post.

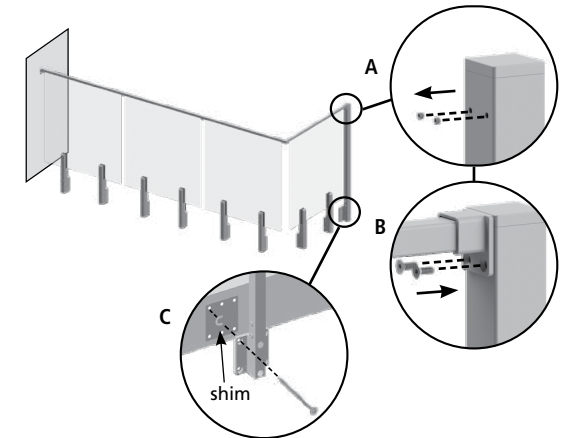

- 14** To secure top rail to end brackets, tighten 5/16" pan head screws with 4 mm hex key.

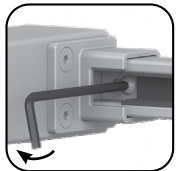

- 15** Install caps onto each fascia post and fascia spigot.

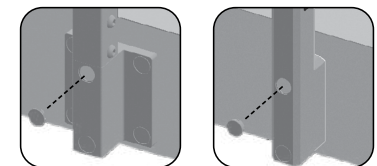

GATE INSTALLATION

! Always use two people to handle glass panels. Always lift a glass panel by its sides. Tempered glass is extremely fragile – do not bump the edges. Always use protective gear including eyewear and gloves when handling glass panels.

1 A. Ensure the required gate opening:

Gate panel size	Gate opening (W)
36"	37½"
42"	43½"

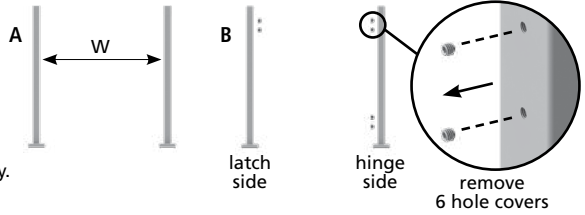

B. Choose gate swing direction, then remove hole covers using 3 mm hex key.

2 A. Fasten latch catch to post with 5/8" wafer head screws using 4 mm hex key.

B. Fasten gate hinges to opposite post with 5/8" wafer head screws using 4 mm hex key.

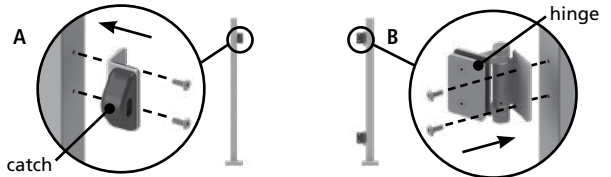

3 A. Remove hinge plates from hinges using 4 mm hex key, leaving plastic grommets in position on hinges.

B. Position gate panel 2-1/2" above deck surface, using wood blocks for support. Align holes on gate panel with hinges and ensure the space between glass and latch side post is 3/8" - 5/8".

C. Fasten hinge plates using 4mm hex key.

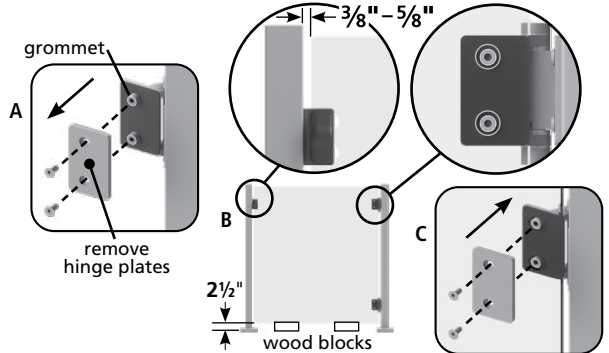

4 A. To remove latch plate and plastic grommets from latch, unscrew two 11/16" wafer head screws using 4 mm hex key.

B. Install latch onto gate panel and fasten using 11/16" wafer head screws with plastic grommets. Do not fully tighten screws; the connection should be loose.

C. Adjust position of latch so there is 1/8" clearance between latch and catch when closed, then tighten screws using 4 mm hex key.

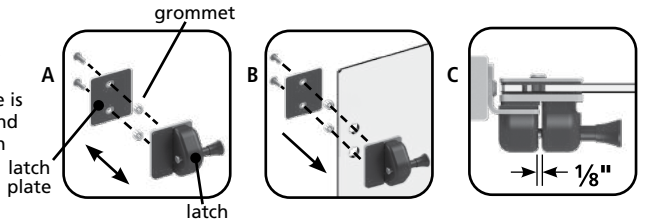

5 To adjust hinge tension:

! Set hinge tension to minimum required to close gate.

A. Unscrew cap next to set screw, then remove washer and inner threaded rod with 2.5 mm hex key.

B. Loosen set screw with 2.5 mm hex key but do not remove.

C. Using 6mm hex key, turn screw clockwise to increase tension or counterclockwise to decrease tension.

D. Hold 6 mm hex key at desired tension and tighten set screw. Turn 6 mm hex key slightly, if needed, to allow set screw to engage.

E. Install threaded rod using 2.5 mm hex key. Then replace washer and screw on cap finger-tight.

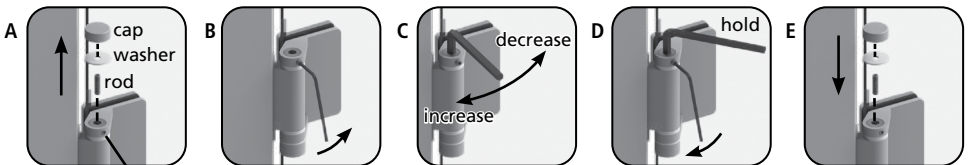

set screw