



Installation Guide

Hand Operated Tools & Materials Needed

- Screw driver
- Tape measure
- Tin snips
- Level & square
- Hammer
- Appropriate protective gear including: gloves, footwear, eyewear, hardhat and clothing
- Security harness

Products For Fascia Installations

Fascia covers available in various widths, heights and lengths

Sill trim 10' in length

Products For Soffit Installations

Soffit panel 10' in length

J-Trim 10' in length

More saving. More doing.™



Important Information

⚠ WARNING Before beginning work, engage professionals: (i) to ensure that these products are appropriate for your intended application, that the structural components for which these products are to be used in connection with are sound and that the work areas are safe and free from all potential hazards including utilities and other services; (ii) to determine how to work safely above ground level and to identify the appropriate apparatus and security harness to be used; and (iii) to provide clarification if these warnings are unclear or you do not understand any of the information in the installation instructions for these products. Comply with all applicable building codes. Building codes may vary. Either before, during or after cutting, metal components may have sharp edges which could fragment. When using tools always comply with the applicable user manuals and instructions. Everyone in the vicinity of any work area must wear appropriate protective gear including gloves, footwear, eyewear, hardhat and appropriate clothing. When working above ground level never use these products to support your weight and use appropriate safety apparatus including an appropriate security harness. Do not use these products in connection with wood that has been treated with Ammoniacal Copper Quaternary (ACQ) or with any other substance that is harmful to these products. Inspect and maintain these products and the structural components that they are used in connection with on a regular basis using professionals when appropriate. Inspection and maintenance includes, but is not limited to, checking for and removing leaves, debris, ice and snow buildup and identifying and repairing cracks, tears, leakage and other damage. Always work in a safe manner.

These instructions have been prepared for certain standard residential applications. Obtain professional advice for any irregular or non-residential application.

Dear Customer,

We'd like to take a moment to say "thank you and congratulations" for choosing our products. At PEAK™ your satisfaction is very important to us. That is why we work very hard to provide you with products of exceptional quality, value, and beauty. And that is also why we want to hear from you. Please contact us with your comments or suggestions at:

quality@peakproducts.com

Or if you prefer, write to us at:

"Customer Care" ~ The Peak Group of Companies
P.O. Box 96060, Richmond, B.C. Canada V7A 5J4.

Finally, we'd like to remind you to always work safely. Then, take pride, relax with your family and experience years of enjoyment with PEAK™ products.

The Peak Group of Companies

Initial Inspection

Ensure that applicable fascia boards and other structural components are sound and free from defect and that all unsound components are replaced and all loose components are securely reaffixed.

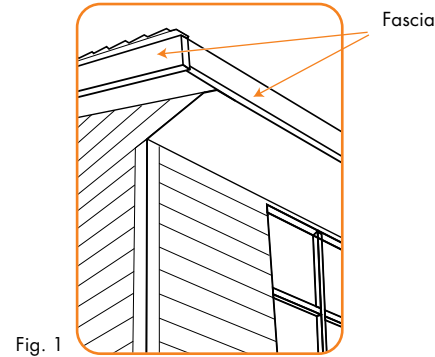

Fig. 1

Fascia Cover Installation

Initial Preparation

Remove any existing gutters and other fixtures attached to applicable fascia boards. Select the size of fascia cover that corresponds to the width and height of the applicable fascia boards (Fig. 2).

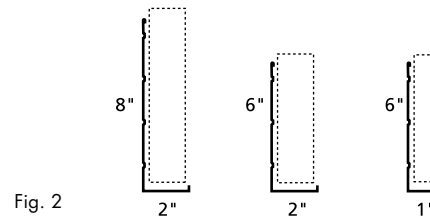

Fig. 2

Applying Fascia Covers To Fascia Board Without Gutters

A. If gutters will not be installed or re-installed on fascia boards, nail sill trim as indicated along the outside top edge of the fascia board (Fig. 3).

B. Butt sill trim end-to-end for applications that are longer than 10' and cut any excess length of the sill trim to fit the exposed fascia board (Fig. 4).

C. Insert the top of the fascia cover into the sill trim and nail the cover to the fascia board as indicated (Fig. 5). Fascia covers should overlap by 2" at their meeting point

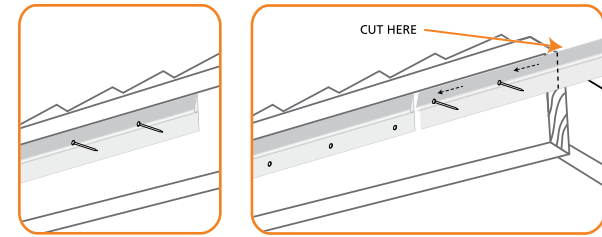

Fig. 3

Fig. 4

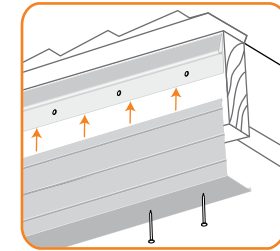

Fig. 5

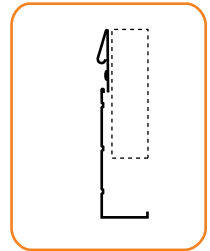

Fig. 5 profile view

along the fascia board. To facilitate the overlap use tin snips to notch the end of the fascia covers by 2 1/2" at the top and bottom (Fig. 7).

Applying Fascia Covers To Fascia Board With Gutters

Sill trim is not required if gutters will be installed or re-installed on fascia boards.

A. Nail fascia covers as indicated directly onto the fascia board before installing or re-installing gutters (Fig. 6).

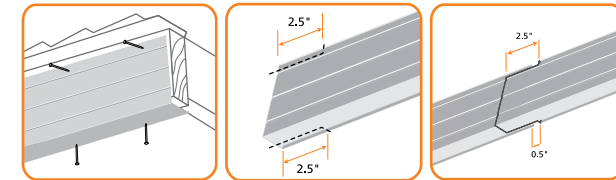

Fig. 6

Fig. 7

Fig. 8

B. Fascia covers should overlap by 2" at their meeting point along the fascia board. To facilitate the overlap use tin snips to notch the end of one of the fascia covers by 2 1/2" at the top and bottom (Fig. 7). Overlap 2" of the notched end of the fascia cover by the adjoining fascia cover leaving a 1/2" gap at the top and bottom for expansion and contraction (Fig. 8).

Obtain Professional Advice For Any Applications That Are Not Described Above.

Soffit Installation

Applying J-trim To Fascia Boards With Gutters Or Existing Wooden Soffits

If fascia board has gutters attached to it that extend beyond the bottom of the fascia board or if there is an existing recessed wooden soffit:

A. Nail the J-trim along the bottom of the fascia board flush with the side of the gutter, if any, (Fig. 9) or along the intersection of the wooden soffit and the inside of the fascia board (Fig. 10).

B. Ensure that the groove of the J-trim faces toward the side of the building and that any existing wooden soffit is well ventilated before applying metal soffit panels.

C. Butt the J-trim end-to-end for applications that are longer than 10' and cut any excess length of the J-trim to fit any remaining fascia boards (Fig. 11).

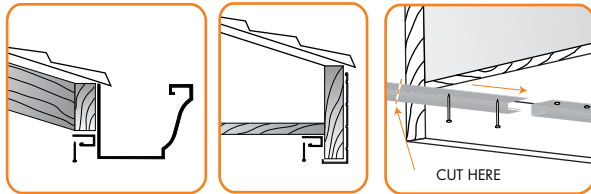

Fig. 9

Fig. 10

Fig. 11

Applying J-trim To Fascia Board Without Gutters

If fascia board does not have gutters attached to it or has gutters that do not extend beyond the bottom of the board and does not have a pre-existing recessed wooden soffit:

A. On the longer side of the J-trim, cut tabs 2" long by 1 1/2" deep along the length of the J-trim at the 16" intervals and bend each tab evenly at a 90 degree angle (Fig. 12).

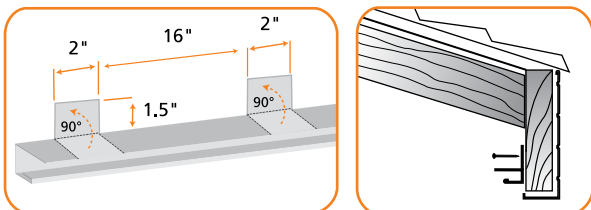

Fig. 12

Fig. 13

B. Position and securely nail each tab of J-trim along the interior side of the fascia board above the lip of the fascia cover, if any, ensuring that the groove of the J-trim faces toward the side of the building (Fig. 13).

C. Butt the J-trim end-to-end for applications that are longer than 10' and cut any excess length of the J-trim to fit the remaining fascia boards (Fig. 14).

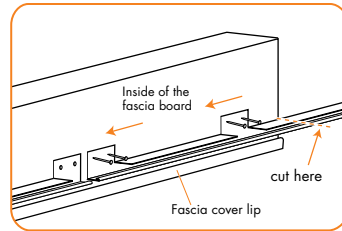

Fig. 14

Applying J-trim to building

If the overhang has a pre-existing recessed wooden soffit:

A. Position the J-trim along the intersection of the wooden soffit and the side of the building so that the groove of the trim is facing directly opposite to, and even with, the groove of the J-trim fastened on the fascia board (Fig. 15).

B. Nail the J-trim securely to the wooden soffit (Fig. 15).

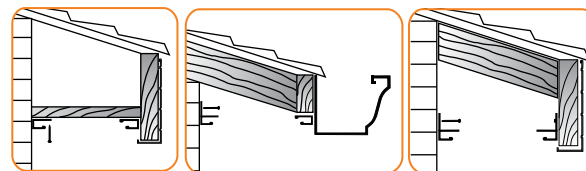

Fig. 15

Fig. 16

Fig. 17

If the overhang does not have a pre-existing wooden soffit:

A. Cut tabs 2" long by 1 1/2" deep along the length of the J-trim at 16" intervals and bend each tab evenly at a 90 degree angle (Fig. 12).

B. Position the J-trim along the side of the building so that the groove is facing directly opposite to, and even with, the groove of the opposing J-trim (Fig. 16 and 17).

C. Nail the tabs of the J-trim securely to the side of the building (Fig. 16 and 17)

Cut Soffit panels

Measure and cut the soffit panels 1/4" less than the distance between the J-trim channels (Fig. 18 and 19).

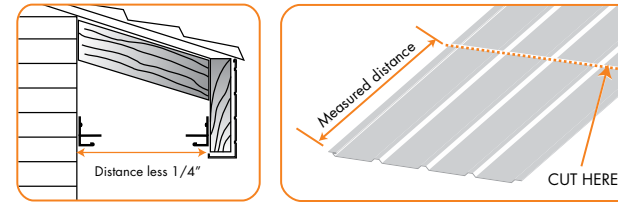

Fig. 18

Fig. 19

Installing and transitioning Soffit panels

A. To install the soffit panels, slide the pre-cut soffit sections into the groove of both segments of J-trim ensuring that each section of soffit inter-connects with the adjacent section to form a continuous series (Fig. 20 and 21).

B. Install the last soffit panel before installing the last section of the outer J-trim. Cap the exposed edges of the panel with J-trim cut to size and nail into place (Fig. 22).

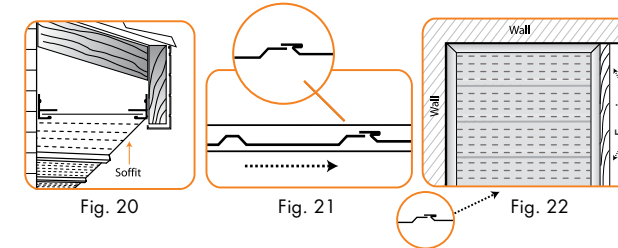

Fig. 20

Fig. 21

Fig. 22

C. To transition the soffit panels at the inside and outside corners of the over hang, cut the soffit panels on an angle (Fig. 23) and secure the panels together by using two pieces of J-trim placed back to back (Fig. 24). Secure each end of the J-trim to the corner of the fascia board and to the interior J-trim with screws.

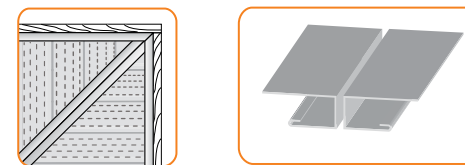

Fig. 23

Fig. 24

Obtain professional advice for any Applications that are not described above.



Component List

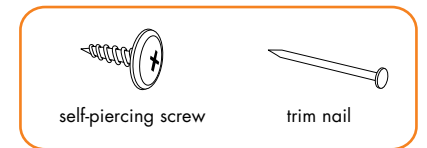
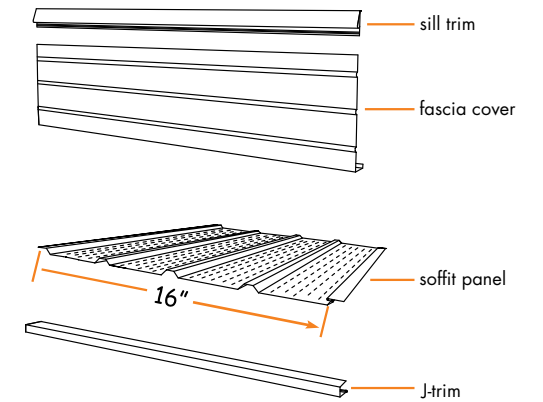

THE HOME DEPOT INSTALLATION SERVICES

Installed Right. Guaranteed.

1-800-HOMEDEPOT



PEAK™ products and the materials associated therewith are protected by patents, designs, copyright and/or trademarks. All trademarks are used under license and are owned by Peak Innovations Inc.

No member of the Peak Group of Companies* shall be liable for any loss or damage resulting from the improper installation or use of any of these products. If any member of the Peak Group of Companies becomes liable for any loss or damage in respect of any or all of these products, the aggregate liability of the Peak Group of Companies shall be limited to the retail purchase price of that or those products.

* The Peak Group of Companies as defined by www.peakproducts.com

P.O. Box 96060, Richmond BC, Canada V7A 5J4

© 2009

I104_V6